

Where to find the Temperature Pressure Relief Valve

The Temperature Pressure Relief Valve can be found on storage models only. It is always near the top of the water heater, at the same level as the hot water outlet. This valve is essential for the safe operation of your water heater.

It is normal for the valve to release a little water through the drain line during each heating period. This occurs as the water is heated and expands by approximately 1/50 of its volume. Continuous leakage of water from the valve and its drain line may indicate a problem with the water heater.

Call Rheem Service on 131 031 or your local plumber for assistance.

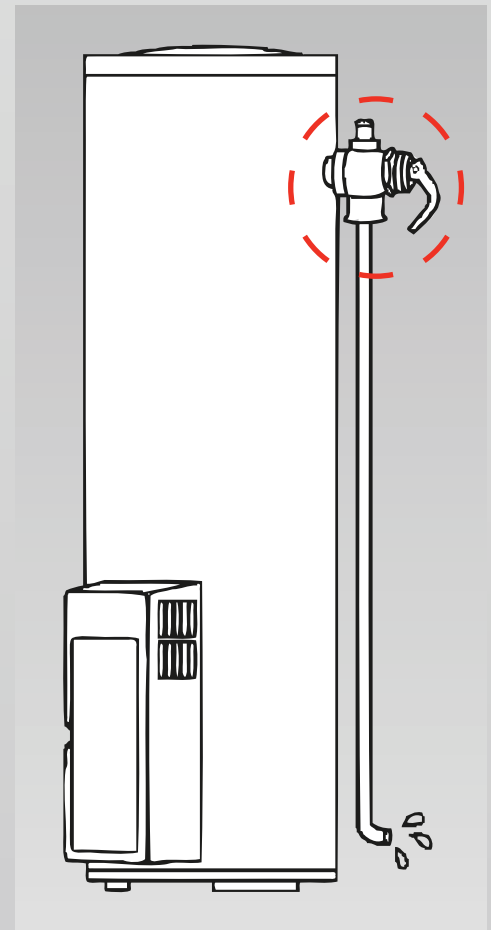

Temperature Pressure Relief Valve

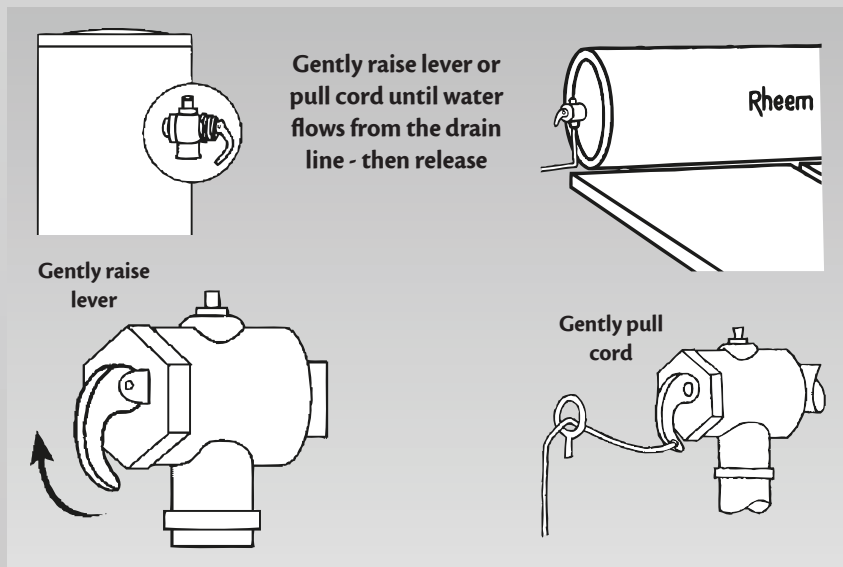

Warning: Never block the outlet of this valve or its drain line for any reason.

It is recommended that you operate the easing lever on the temperature pressure relief valve once every six months. This is achieved by gently lifting the lever or pulling the cord attached to the lever. It is very important you pull and release the cord or lever gently.

DANGER: Failure to do this may result in the water heater cylinder failing, or under certain circumstances, exploding.

If water does not flow freely from the drain line when the lever is lifted, then the water heater should be checked by Rheem Service or your plumber. The temperature pressure relief valve should be checked for performance or replaced at intervals not exceeding 5 years, or more frequently in areas where there is a high incidence of water deposits.